

DATE	DR.BY	ECN.NO.	DESCRIPTION	MARK	VER.
3/29'16			NEW DWG		AO

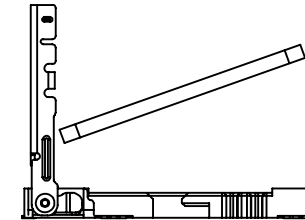

STEP 1 INSERT NANO SIM CARD

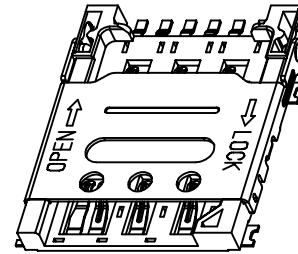
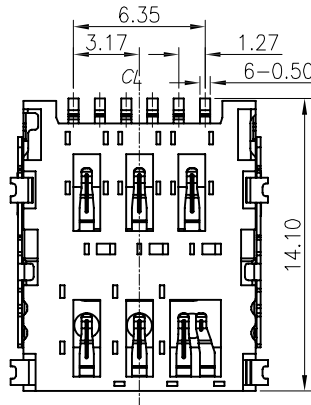
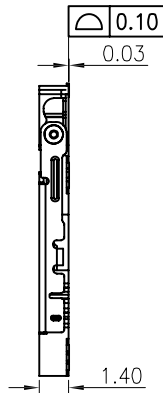
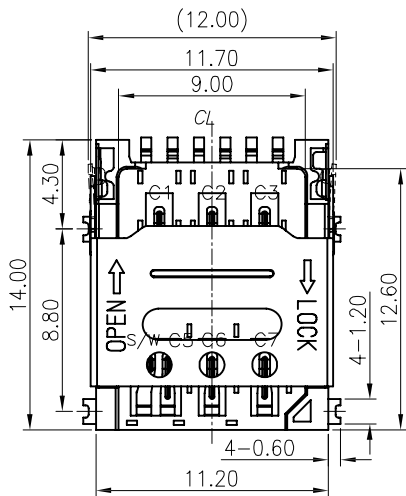
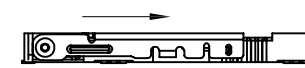

STEP 2 PUSH THE SHELL



STEP 3 FINISH

NOTES:

1. MATERIAL:

- 1.1 Housing: High Temperature Thermoplastic UL94V-0; Color Black.
- 1.2 Terminal: Copper Alloy, T=0.12mm.
- 1.3 Shell: Stainless Steel, T=0.20mm.

2. FINISH:

- 2.1 Terminal: Plated Gold on the Contact Area and Solder Tails
- 2.2 Peg: Plated Gold on the Solder Tails.

3. SPECIALITY:

- 3.1 Rated current: 0.5A
- 3.2 Rated voltage: 50V
- 3.3 Contact Resistance: 50mΩ MAX
- 3.4 Insulation Resistance: 100MΩ MIN 100V DC
- 3.5 Dielectric withstanding voltage: 100V AC.
- 3.6 Durability Cycles: 5000 Cycles.
- 3.7 Solder ability: 245±5°C, 5±0.5s.
- 3.8 Operating condition: Temperature: -30°C +80°C Humidity: 80% R.H MAX

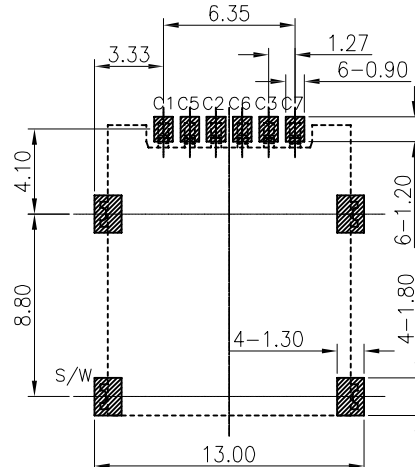
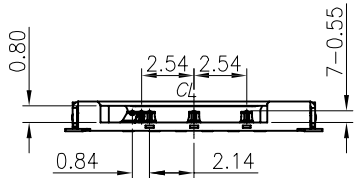

RECOMMENDED PCB LAYOUT

TOLERANCE ±0.05

■ SMT SOLDER AREA

PIN NO.	PIN NAME
C1	VCC
C2	RST
C3	CLK
C5	GND
C6	VPP
C7	I/O
S/W	Switch Pin

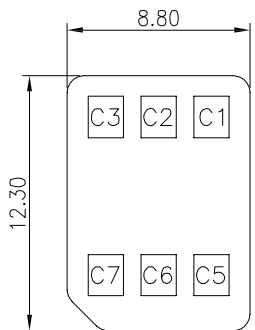

Circuit Diagram for Card Detect Switch

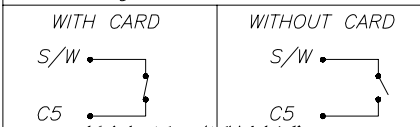

-TOLERANCES- UNLESS OTHERWISE SPECIFIED 公差参考表		东莞市龙科电子科技有限公司 DONGGUAN LONGKE ELECTRONICS CO.,LTD.					
		TITLE: 产品品名: 1.4H NANO SIM CARD	PRODUCT NO: 产品料号: 197-F063G430-B55				
X.X ±0.30	X.X° ±3.00°	APPD: 核准:	DATE	SCALE	UNIT	TYPE	PAGE
X.XX ±0.15	X.XX° ±1.00°	CHECK:dd 校对:	2016.03.29	1:1	mm	CD	1/1
X.XXX ±0.05	X.XXX° ±0.500°	DRAW: 绘图: 罗求新					